



UNLEASH THE POWER OF EVERPADS

Transforming Your Pavement Construction Experience



| COLD MILLING MACHINE

| ASPHALT PAVER

| VIBRATORY ROLLER

| VIBRATORY HAMMER

| EXCAVATOR



TABLE OF CONTENT >>

01 ABOUT EVERPADS 01-02

02 COLD MILLING MACHINE 03-26

03 ASPHALT PAVER 27-30

04 VIBRATORY ROLLER 31-34

05 VIBRATORY HAMMER 35-40

06 EXCAVATOR 41-42

ABOUT EVERPADS

#1 trusted manufacturer by operators 30 years of experience

OUR JOURNEY: INNOVATION, SUSTAINABILITY, AND EXCELLENCE

Established in 1995, EVERPADS draws upon a 60-year family legacy entrenched in the rubber industry. Our founder, Leo Chiang, leveraged this extensive expertise to pioneer transformative solutions in road construction. Recognizing the challenges faced by our customers and using his advanced knowledge of high-grade solid rubber, Leo's innovative approach culminated in the invention of the first bolt-on rubber track pad. Since then, EVERPADS has expanded its offerings, manufacturing diverse parts to meet industry needs. Our commitment to innovation and quality ensures comprehensive solutions for our customers' projects.



GLOBAL EXCELLENCE

Delivering Uniquely Optimized Solutions In Over 80 Countries

EVERPADS has provided uniquely optimized solutions to customers in 80+ countries. Founded by Leo Chiang, we empathize with equipment owners' challenges and offer reliable, high-quality, and cost-effective solutions. With unrivaled expertise in rubber and road machinery spare parts, EVERPADS is the go-to global destination for spare parts, recognized by over 100,000 operators worldwide.



OUR MISSION

Timely completion. Exceptional value. Climate-positive impact.

Dedicated to ensuring timely project completion, we offer exceptional value, revolutionary design, and a positive global impact through our reliable solutions and spare parts. With complete in-house operations, we maintain credibility, oversight, and the highest standards of quality control and assurance. Our meticulous processes optimize efficiency and quality, eliminating bottlenecks and reducing downtime to deliver state-of-the-art, cost-effective solutions to our customers.

MILESTONES / TESTIMONIALS



- Brand founded.
- Established the head innovation department in California, USA.
- Specialized in rubber products for heavy-duty machinery.
- Pioneered research and development efforts.
- Granted a patent for Bolt-on track pads.



- Initiated a solution partnership with Wirtgen.
- Developed new patent designs.
- Unveiled built-in patent design.
- Introduced the quick-change blade adapter system (patent design).
- Presented the patent design for the track chain and chassis conveyor roller system.



- Initiated R&D for E-Series Milling and Undercarriage System Parts.
- Decided to end the partnership with Wirtgen, focusing on our own products.
- Gained trust from over 100,000 operators globally.
- Expanded services to 80+ countries.
- Established over 30 trusted dealerships.
- Unveiled the first edition of E-Generation Undercarriage System Parts.



- Unveiled the second edition of Gen-E Milling Teeth as part of the E-Series Milling System Parts.
- Established a new industry benchmark; the second version of Gen-E Milling Teeth delivers up to 70% longer service life compared to upper-mid-range alternatives.



"Everpads milling teeth T6W, and T7WS are four times more efficient than W-Brand. Idlers and roller designs are reliable. They never popped out while running. OEMs might leak, or the chain might pop out. Everpads' products outperform the OEMs significantly."

Scott Nickel
HC Howell & Sons Trucking Inc.



"Now we save 33% of repair costs and haven't received any customer complaints about the service. Plus we have increased our profit margin by 27%, after using Everpads products instead OEMs"

Mr. Chang, Chief Technology Officer
Wan Qian Machinery LTD



"Our customers have been satisfied with Everpads products. We have not gotten any negative feedback for years."

Daryl Pfaff, Mechanical Design Engineer
Good Earth Tools



COLD MILLING MACHINE

“EVERPADS provides 80 percent of the asphalt milling machine model parts for major brands, such as Wirtgen, Caterpillar, and more, which trust our manufacturing precision.”

30 YEARS OF EVOLUTION MAKE US A GLOBAL LEADER IN ROAD MACHINERY SPARE PARTS MANUFACTURING.

For the past 30 years, EVERPADS has been active in more than 10 million successful construction projects with 48,000 customers worldwide, making our company and products world-renowned because of our focus and expertise on heavy machinery spare parts. We know how difficult it is to complete a construction project when spare parts contribute to high maintenance costs and machine downtime. These are the primary reasons why EVERPADS has dedicated our efforts to developing and manufacturing high-performance spare parts.

EVERPADS IS AT THE FOREFRONT OF MILLING MACHINE SPARE PARTS MANUFACTURING

At EVERPADS, with our significant R&D investments, we are continually discovering and implementing operational advantages and cost-saving spare parts solutions for optimizing milling machine performance.

The tool holder system and milling drum are several of the milling system's core technologies, and we've improved both with multiple innovative worldwide patented designs to surpass other market brands.

In addition to our superior milling teeth, see why our patented TH12 Quick-change Tool Holder and Gen-E Milling Drum give your milling projects the edge needed to achieve each unique project's goals.

GEN-E MILLING SYSTEM FOR COLD MILLING MACHINE

New Industry Benchmark for Milling Spare Parts
for Cold Milling machines

GEN-E MILLING TEETH: Revolutionize Your Milling Experience

Unlock the full potential of your cold milling machine with GEN-E Milling Teeth – where innovation meets efficiency. Our patent-structured design is engineered to optimize rotation efficiency, significantly extending the lifespan and enhancing cutting performance.

COST EFFICIENCY REDEFINED

1.7x More Cost-Efficient

Superior performance at a fraction of the cost compared to upper-mid-range alternatives.

2% Lower Partial Wear Rate

Experience a substantial reduction in wear and tear, ensuring longer-lasting efficiency.

TESTIMONIAL

★★★★★

“T6W, are as good as the W-brand milling teeth. We are ready to buy the entire undercarriage for the W120.”

Fred Massaro, General Superintendent
LAYDON INDUSTRIES

★★★★★

“Milling teeth T6W. THEY ARE WORKING WELL; They Don’ t have TO USE AS MUCH AS THEY NORMALLY HAVE Compared to OEMs.”

BRITTNEY KEYS, Manager
Platinum Paving and Co

HOW GEN-E MILLING TEETH PROVIDE SUPERIOR PERFORMANCE

WEAR PLATE

EVERPADS patented wave-shaped wear plate. This cutting-edge design centralizes the milling teeth to withstand high cutting forces, dramatically improving rotation efficiency and uniformly distributing wear to extend the life of the milling teeth. Engineered with a robust 4mm thickness, the wear plate not only prolongs the durability of the milling teeth but also provides superior protection for the tool holder.

CLAMPING SLEEVE

Composed of a special material with advanced heat treatment, the clamping sleeve ensures precise and long-lasting tension of the milling tooth within the tool holder. This design allows for smooth rotation, effectively reduces internal friction, and enhances inertial wear resistance.

GEN-E CARBIDE TIP

Crafted in a high-pressure atmosphere using the most advanced sintering furnace, our carbide tips are sourced from leading global providers. With a hardness of up to 95 HRC, these tips are designed to endure the rigorous forces of milling operations.

E-CODE STEEL BODY

Made from a special high wear-resistant alloy steel, our steel body boasts a proprietary wave shape. This unique design enhances rotational efficiency, offers better protection to the tool holder, and prolongs the lifespan of your milling teeth.

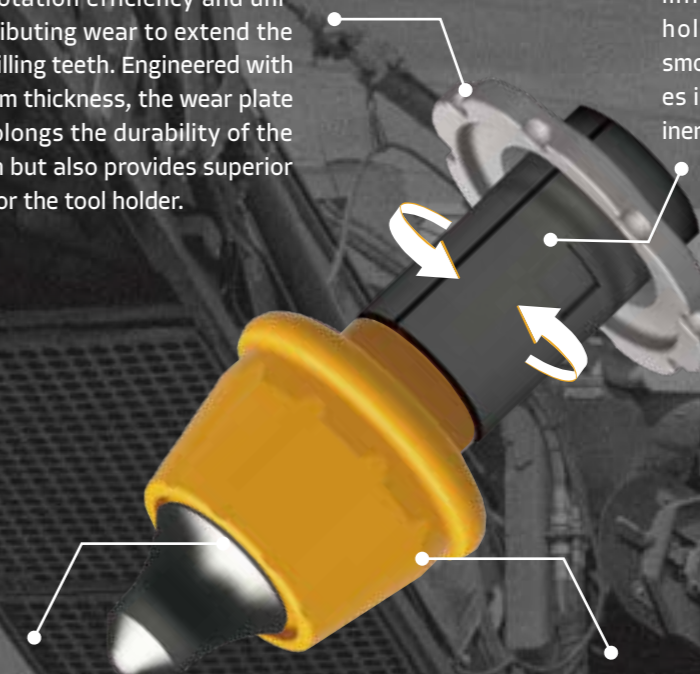

GEN-E MILLING SYSTEM FOR COLD MILLING MACHINE

E-TYPE MILLING DRUM: Power Up Your Milling For The Next Half-Decade

Elevate your milling operations with EVERPADS' E-Type Milling Drum – a masterpiece of engineering designed to deliver unmatched precision and performance. Drawing on over two decades of expertise and extensive field testing, we present a milling solution that promises satisfaction not just as a goal, but as a guarantee. Expect exceptional line patterns and surface evenness that redefine milling excellence.



PATENTED GROOVE DESIGN IN TOOL BASE:

This innovative feature offers the ultimate protection for the tool holder system. The design not only minimizes wear and tear but also extends the lifespan of your milling drum while enhancing load capacity for more rigorous milling tasks.

AUTOMATIC 3D ALIGNMENT TECHNOLOGY:

At EVERPADS, we employ an automated robotic manufacturing process, ensuring consistent and precise line spacing and superior milling results. This cutting-edge technology sets a new standard in milling precision.

#Specialize in Wirtgen and CAT
#Customization services available

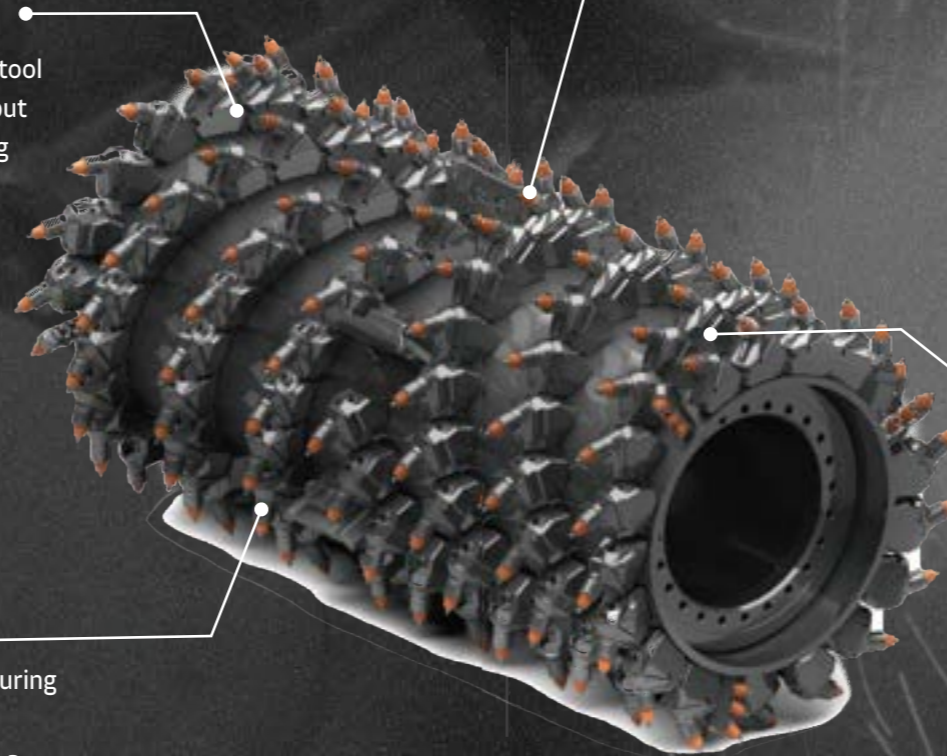

ADVANCED TOOL SYSTEM ALIGNMENT:

Engineered with precision, our advanced alignment ensures the most accurate line spacing and surface texture. Every operation is flawlessly executed, making each pass more efficient and effective.



OPTIMIZED TOOL BASE ALIGNMENT & ANGLE:

Our design is strategically crafted to maximize waste material collection and ejection, boosting efficiency and significantly cutting down on operational downtime.



“After milling over 1300 operational hours (and still going strong), we're gearing up for the purchase of our second 2-meter drum. The milling performance holds its own against the original, and the cutter holders have been rock-solid, with just a minor torque adjustment needed for one or two picks. Maintenance is a breeze, even better than the original, and the best part? It comes at a more budget-friendly cost.”

Mr. Bai, General Manager
Jinhua Road Construction Co., Ltd

GEN-E MILLING SYSTEM MANUFACTURER CREDIBILITY

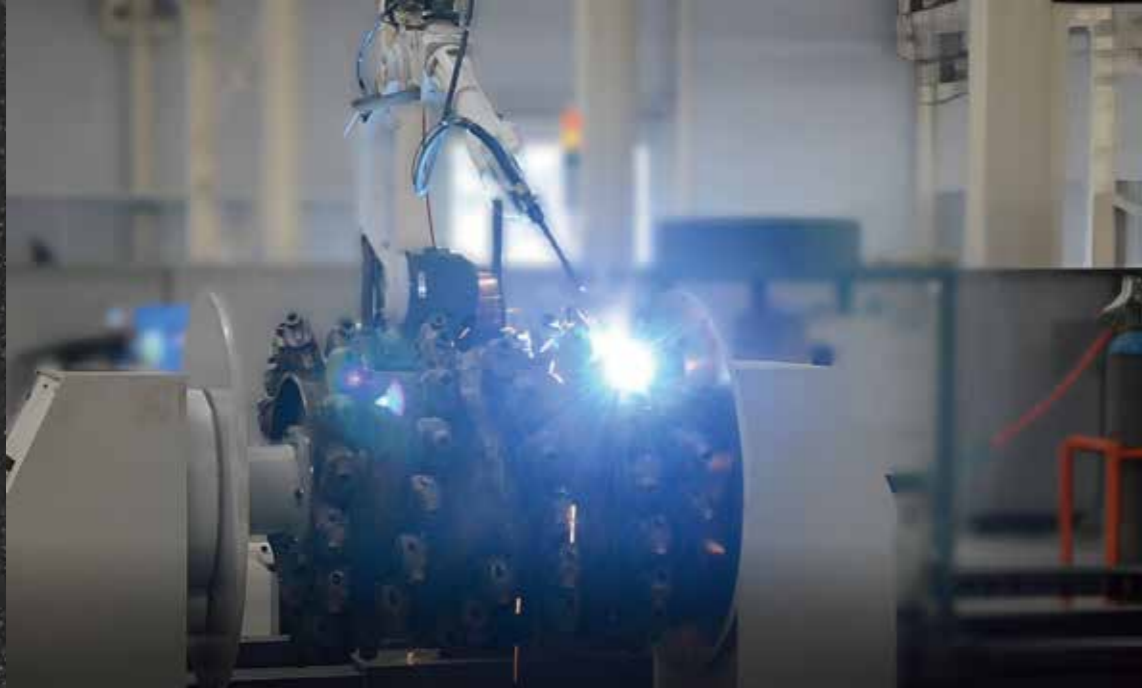

EVERPADS, as an OEM manufacturer, offers a premium solution with the highest milling drum standard without a premium cost. We are ready to scale to our customer's needs with reliable milling drums, offering a variety of milling drums for your cold milling machine model.



DYNAMIC EQUILIBRIUM ADJUSTMENT

The best result for every milling construction is achieved with dynamic equilibrium, avoiding uneven milled surface. At EVERPADS, we confidently provide and ensure the most consistent quality to our customers.

FIT YOUR COLD MILLING MACHINE MODEL

Ensuring that your machine model has the correct dimensions is crucial, yet it's a common challenge with many other after-market suppliers. For example, even within the same milling machine model, different serial codes may have varying installation dimensions. This variability makes it challenging for aftermarket suppliers to consistently provide the appropriate milling drum for specific machine models.

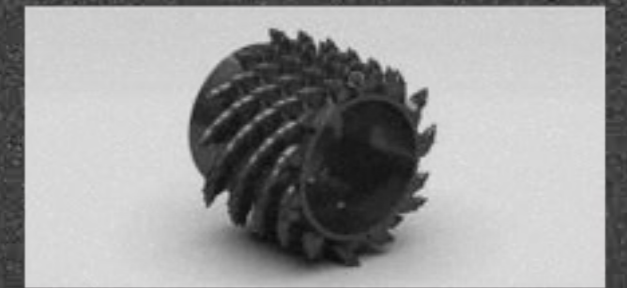
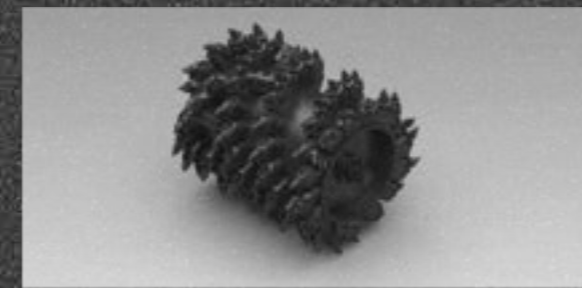

GEN-E MILLING SYSTEM FOR COLD MILLING MACHINE



TH12 QUICK-CHANGE TOOL HOLDER

One of the challenges operators face is the maintenance requirement for the tool holder (upper part), installed on the tool base, which needs attention every 500 hours to prevent wear and tear to the tool base. Our tool holder addresses this challenge by providing the following solutions:

GREATER WEAR VOLUME FOR LONGER SERVICE LIFE

Increased wear volume of the tool holder contact area protects the tool base from waste particles during the milling operation for a longer lifespan.

OPTIMIZED CENTER BEVEL ANGLE

The TH12's center bevel angle is meticulously calibrated to maximize the rotation efficiency of milling teeth. This means more consistent, efficient milling with every use.

OPTIMIZED GEOMETRIC DESIGN

Built to withstand the toughest conditions, our geometric design effectively absorbs higher cutting forces. This translates into smoother operation and reduced wear on your equipment.

PROPRIETARY SHANK DESIGN:

Our innovative proprietary shank design fully centers with the tool base, assuring maximum centralized attachment for the tool base itself to prevent tool holder loosening. Therefore, it is not solely dependent on the tool holder bolt, never loosening and increasing the milling drum's service life.

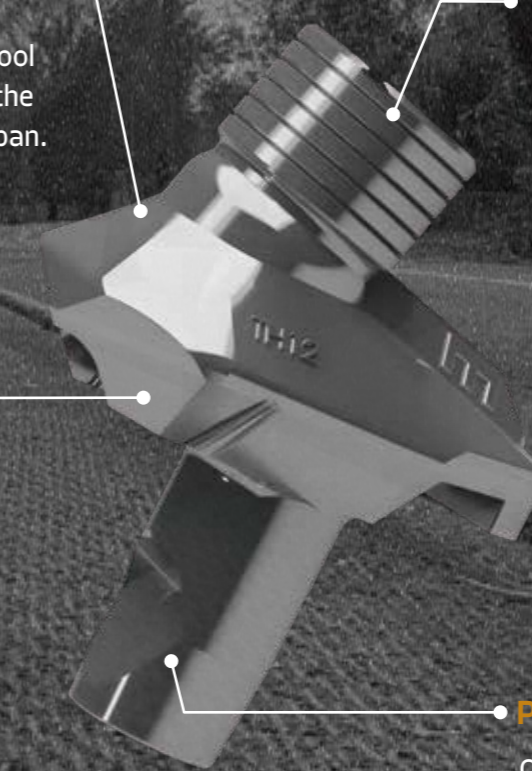

EVERPADS



EJECTOR

The E-Generation Milling System

The EVERPADS wear-resistant ejector prolongs the service life of the milling drum for cold milling machines because its well-designed shape is more effective at removing milled road material, resulting in increased productivity and minimized project costs. Its patented shape has a claw on both sides, which gathers the materials together and prevents them from escaping the enclosed grip. Forged with wear-resistant alloy steel, the ejector also features a mounting receptacle to ease replacement and is built for easy reception of most milling machines to maximize productivity.

GEN-E PROTECTOR SKID

The Gen-E Protector Skid enhances the front head's durability, offering superior impact and wear resistance against uneven road surfaces. This enhancement ensures cost savings and a prolonged service life for our clients, delivering a reliable and economical solution.



GEN-E SCRAPER BLADE

The Gen-E Scraper Blade secures a tight enclosure within the milling drum's chamber, efficiently facilitating the removal of milled road material and achieving a smooth finish on the milled surface with its carbide-tipped scrapers.

Up to **1500** hours **30%** thicker
3X layers of wear-resistant carbon

PRODUCT FEATURES

- Maximum Productivity:** Gen-E Protector Skid offers 30% more wear volume, prolonging operational intervals and saving you time and money.
- Ideal for All Milling Tasks:** Featuring three layers of high-wear-resistant carbon that stands up to the most demanding conditions.
- Impact Resilience:** Absorbing excessive force to ensure milling house safety and longevity.

Up to **800** working hours

PRODUCT FEATURES

- Premium German Carbide:** Featuring premium-grade carbide sourced from Germany, our Scraper Blades offer unmatched durability for peak performance.
- Superior Wear Resistance:** Engineered with a specialized compound to significantly outperform standard options in wear resistance, reducing maintenance expenses.
- Uniform Contact Design:** Designed for high, even contact layout, ensuring consistent wear and extended lifespan.

E-GENERATION EV POLYURETHANE TRACK PADS

EV POLYURETHANE TRACK PADS: Redefine your track pad benchmark

The EVERPADS polyurethane (poly) track pads contain the highest grade of polyurethane. This combination of deep knowledge and quality materials has given our customers assurance that their construction projects will benefit from enhanced performance and cost-savings.



PRODUCT FEATURES:

PATENTED CHAMFER DESIGN FOR ENHANCED MOBILITY:

Experience advanced quality and steering agility with our meticulously designed chamfer edge. This feature allows cold milling machines to navigate rugged surfaces with ease, reducing wear and tear and enabling them to handle intense construction demands.



PROPRIETARY EV POLY COMPOUND:

The E30 poly formula is specifically designed to enhance durability under heavy operations and support maximum weight, significantly extending service life.

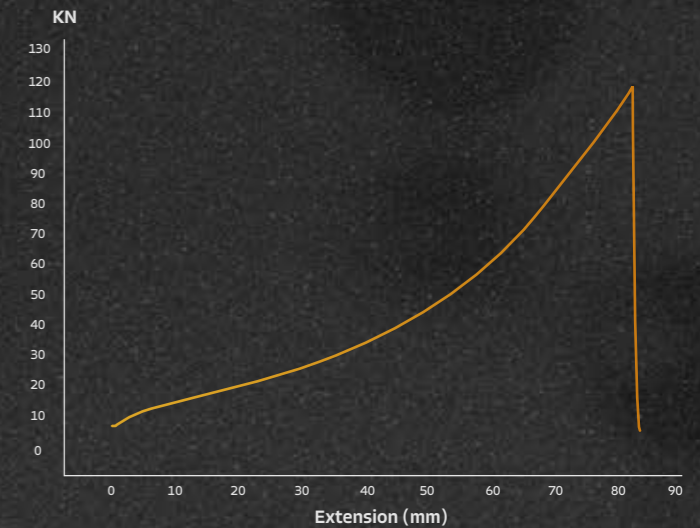

INCREASED TEAR RESISTANCE:

EVERPADS was first to design and engineer poly track pads to create a high tear and abrasion-resistant formula. This special compound increases tear resistance capability by up to 130 kNm to minimize the chipping on the poly track pads when moving on milled side edges.

SUPERIOR STRUCTURAL DESIGN FOR HEAVY-DUTY SUPPORT:

Our proprietary support frame and built-in steel plate are crafted to sustain cold milling machines weighing up to 42 tons, ensuring stability and longevity.

BENCHMARK REDEFINED

Up to **1600** working hours

Up to 1,600 actual working hours, while the top 30% of products in the market last only up to 1,100 hours.

1000 hours warranty

Engineered to eliminate the worry of premature failure. No more unexpected chipping - just consistent, dependable quality.

Certified Performance

Our commitment to transparency and excellence is backed by SGS third-party certifications, ensuring that you receive a product that meets the highest standards.



“Everpads’ Poly Pads showcased exceptional endurance, surpassing 1,260 working hours with no signs of wear. This remarkable resilience minimizes downtime and maintenance costs, the most impressive part is the pads never unexpectedly fail. Truly impressed with the product’s performance!”

Mr.Su, Operation Manager
Da-Lian Asphalt Ltd Co.

E-GENERATION FORMULA E LAMINATED WHEEL

Formula E laminated wheels from EVERPADS feature 100% natural rubber with a special rubber compound and can be customized to fit most industrial and commercial purposes. Our laminated wheel products never fall off, providing supreme quality for longevity. The continuous high-standard laminations, wound over standard macerated centers, produce excellent resistance to fraying, resulting in higher impact strength than conventional laminated wheels.



1000+ Working Hours

Endure the Long Haul: Achieve over 900 working hours with Formula E laminated wheels, showcasing superior durability and impact strength for heavy-duty usage.

100% Natural Rubber

"Naturally Tough": Crafted from 100% natural rubber with a special compound, EVERPADS laminated wheels deliver unmatched quality and longevity, enhancing traction and operator experience.

ANTI-AGING RUBBER TECHNOLOGY

Formula E

At EVERPADS, we implement our proprietary advanced technology, Formula E, in our laminated wheels. This innovative technology effectively retards the aging and fatigue of rubber, maintaining a consistent temperature of 63°C or 145.4°F. Consequently, our laminated wheels exhibit prolonged service life and sustained excellent performance characteristics, ensuring optimal functionality even during rigorous heavy-duty construction projects.

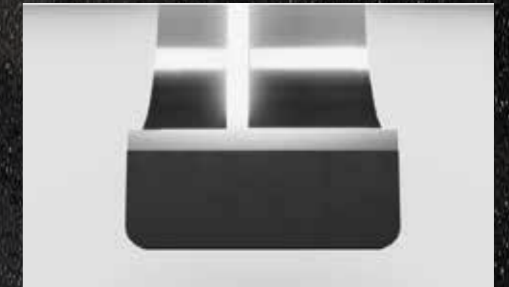

SPECIAL RUBBER COMPOUND

The special rubber compound, renowned for its excellent impact and vibration absorption capabilities, not only protects your undercarriage system but also enhances the operator's experience. Our high-grade manufacturing is specifically designed to provide better traction and agility.



EXTENSIVE SURFACE TREATMENT

Reliable rubber and steel connection with multi-treatment ensure the long service life

Multi-treatment surfaces provide peak adhesion between the rubber and steel for heavy machine wheels, ensuring consistent movement.



E-GENERATION X-TYPE TRACK CHAIN

X-TYPE TRACK CHAIN: Reinventing Durability For Heavy Machinery

Introducing the revolutionary X-Type Track Chain, engineered to meet the demanding needs of heavy-weight machinery like cold planers. Our new generation track chain is meticulously designed to enhance structural strength, ensuring your operations remain smooth and safe throughout its lifespan.

Everpads' X-type chain: **40%** Thicker, distinguished by Red Color

TAPERED BEARING SYSTEM FOR UNMATCHED ENDURANCE:

-Elimination of the Weakest Link: The pin sleeve hole, a historically weak point in track chains, is now reengineered for unparalleled durability. Our design boasts a 38% increase in tensile strength, withstanding up to 800 kN at 200 mm displacement.

-40% Thicker Body: The X-Type track link features increased body geometry and contact surface thickness, offering superior strength and longevity.

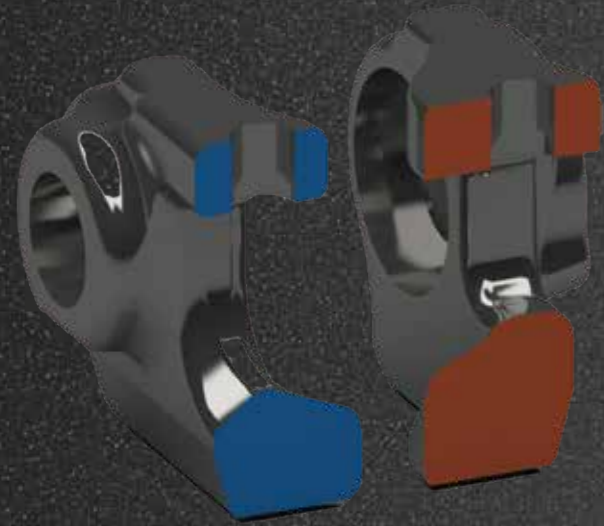

ADVANCED MANUFACTURING PROCESS FOR UNMATCHED QUALITY:

-Enhanced Heat Treatment: Our ABP medium frequency heating treatment significantly improves hardness and wear resistance, extending the chain's service life.

-Precision Automatic Tightening Process: Utilizing advanced automation centering process, we ensure precise dimensions for each track chain, resulting in unmatched accuracy and stability.



Everpads' Patent Pin Sleeve Hole Design

ELIMINATES THE WEAKEST LINK IN THE TRACK CHAIN

The weakest link of the track chain is the pin sleeve hole that often breaks when the chain link can't withstand the stress of uneven forces. EVERPADS introduces the proprietary track links by reengineering the geometry of the pin sleeve hole. This reengineering increases the tensile strength by 38 percent, allowing it to withstand up to 800 kN with 200 mm displacement. This upgrade provides mechanical strength for every movement to help contractors and operators complete heavy construction workloads.

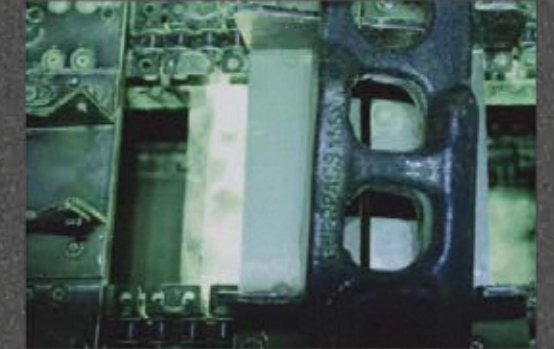

Quality Control

We utilize automated inspections for defects, inspecting every chain link before assembly.

Automatic Tightening Process

Because of our advanced automation centering process, all the dimensions are precisely matched to the mounting hole that ensures track chain accuracy and stability.



E-GENERATION TRACK ROLLER

E-GENERATION TRACK ROLLER: Revolutionizing Reliability



OLD

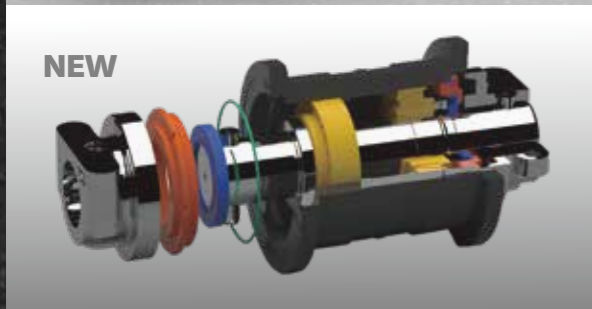

NEW

Say goodbye to the frequent and frustrating issue of **oil leakage in track rollers**. The E-Generation Track Roller from EVERPADS, with its patented design, virtually eliminates oil leakage, ensuring your machinery moves forward without interruption. Experience the peace of mind that comes with 99% less oil leakage and steadfast support in your construction endeavors.

Everpads' patent **HEAVY-DUTY SEALED SYSTEM** eliminates the Oil Leakage issue.

ADVANCED PATENT HEAVY-DUTY SEALED SYSTEM:

-Oil Leakage Prevention: Our redesigned track roller structure significantly prevents oil leakage, maintaining 99% effectiveness.

-Robust Safeguard Mechanism: Designed to sustain functionality during unforeseen challenges, such as encountering hard objects or tilting during construction processes.

-Gen-E Sealed System: Expertly contains lubrication within the roller, facilitating continuous and smooth movement.



Oil Leakage: Primary Cause of Premature OEM Track Roller Failure

TAPERED BEARING SYSTEM

Our state-of-the-art tapered bearing system ensures maximum durability and stability during operation, reducing friction and wear and tear on the machinery. This system is engineered to provide reliable performance and prevent equipment failures, even in the most punishing work environments.



SUPERIOR LUBRICATION: LOW HEAT COEFFICIENT

EVERPADS high-quality roller oil provides internal lubrication and maintains an optimal internal temperature, ensuring peak accuracy and consistency in your machinery's movement. With this state-of-the-art lubrication system, your equipment will perform at its best, even under the most extreme conditions. The robust roller is engineered for durability and can handle even the heaviest machines. Trust in our innovative lubrication system to keep your machinery running smoothly and efficiently for years to come.



TAPERED BEARING SYSTEM FOR UNMATCHED ENDURANCE:

-Maximum Durability: Our state-of-the-art system effectively reduces friction and wear, enhancing the operational lifespan of the roller.

-Reliable Performance: Built to withstand harsh work environments, it ensures stability and durability where it counts.

-Superior Lubrication with Low Heat Coefficient: Our high-quality roller oil not only provides essential internal lubrication but also maintains an optimal internal temperature, ensuring efficiency.



W2000, W210i

"Everpads Idlers and roller designs are reliable. They never popped out while running. OEMs might leak, or the chain might pop out."

Scott Nickel
HC Howell & Sons Trucking Inc.

E-GENERATION IDLER ROLLER

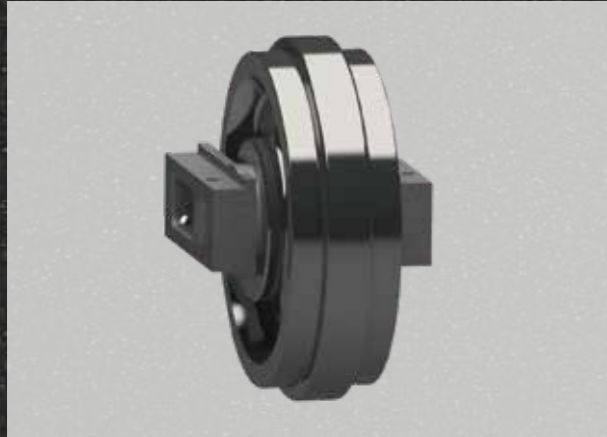

Introducing the E-Generation Idler Roller, a pinnacle of engineering designed to enhance the performance and longevity of your milling machine. Our idler rollers are a testament to innovation, featuring a cutting-edge bearing system and precision craftsmanship.



Advanced Bearing System for Superior Performance:

- **Patent-Imported Floating Oil Seals:** These state-of-the-art seals are key to the idler roller's extended lifespan, significantly reducing heat generation and wear.
- **Extended Service Life:** Crafted with a heat-treated surface and forged structures, our idler rollers are built to last, enduring the rigors of heavy use with ease.
- **Zero Heat Generation:** The imported bearing system is meticulously designed to minimize heat generation, ensuring smooth operation and preserving the integrity of the roller.

PRECISE TRACK GUIDANCE FOR UNMATCHED RELIABILITY:

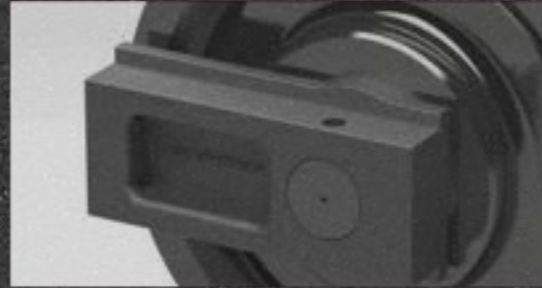

HIGH-QUALITY CASTING STEEL

Each EVERPADS idler roller is crafted from premium casting steel, ensuring strength and durability.

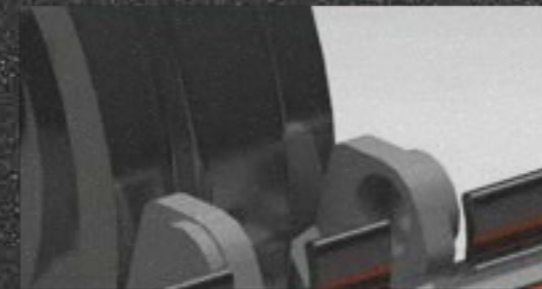

PROPER HEAT TREATMENT

Our rigorous heat treatment process guarantees a precise and heat-treated surface, optimizing performance and resilience.



PRECISE TRACK GUIDANCE

EVERPADS Idler Rollers have a significant impact on the operation of cold milling machines, pavers, and excavators. Whether it's the front or rear of the undercarriage, our Idler roller products effectively propel the machine forward and backward.

E-GENERATION SPROCKET



Cold, hot, and humid environments can affect performance if sprockets lack sufficient strength for efficient torque transfer between shafts. Inadequate strength can also lead to bending and breakage.



The EVERPADS sprocket product outlasts conventional surface-hardened sprockets because it undergoes proper heat treatment, exceeding OEM standards.

LONG SERVICE LIFE

Our sprocket products have a longer service life due to the effective heat treatment technology, which enables them to provide maximum wear resistance while enduring high load capacities.



PRECISELY MATCHED WITH TRACK CHAIN

EVERPADS-owned intelligent manufacturing delivers precise machinery processing that accurately matches most track chains. The customizable options of EVERPADS' sprockets can match various chains and applications.



CONVEYOR SYSTEM FOR COLD MILLING MACHINE

CONVEYOR BELT

EVERPADS takes great pride in our rubber products, and when it comes to the conveyor belt, continuity counts, as well as the utmost loading capacity and stability. Due to the high quality of the rubber raw material and the latest hot vulcanization technology, the conveyor belt is produced in one process, assuring a long service life. The Y-shape threads help to strengthen the entire structure that carries the milled material effectively out to the truck.

Additionally, we offer various specifications of conveyor belts tailored to different machine models, providing the highest quality rubber materials with up to 5 layers specific to the cold milling machine make and model.



SUPPORT ROLLER

The EVERPADS Support Roller includes roller bearings with labyrinth seals to reduce friction, thereby extending the service life of the conveyor system. The easily attachable idle pulley with a plow groove optimizes conveyor efficiency, while the hardened bearings help maximize loading capacity.



BELT ROLLER & GUIDE ROLLER

Our roller products instill stable operating guides, centering the conveyor belt and providing accurate guidance in stringent environments. In addition, the EVERPADS special rubber compound with low abrasion flow makes these rollers more wear-resistant, adding considerable value to the overall system.



RETURN ROLLER



No asphalt adhesion
Shaped with an open design principle.

Performs well in severe conditions

Won't deform due to its strict intrinsic structure.

Stable operation
Features nine support bars.

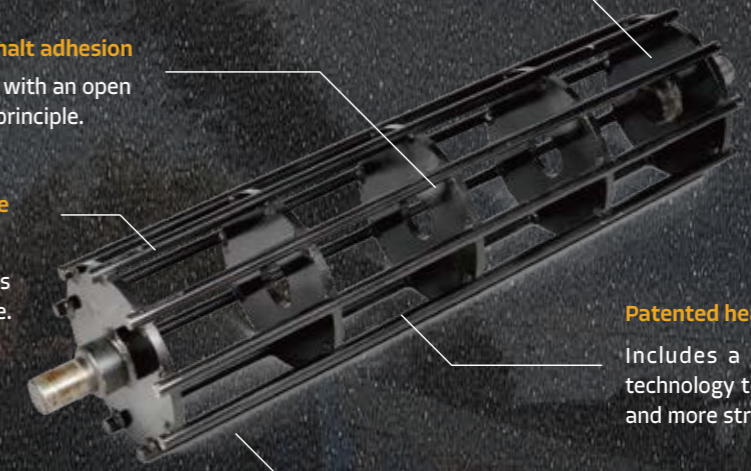

Patented heavy-duty rubber
Includes a special adhesive technology to boost its lifespan and more stress absorption.

Guaranteed effective performance

Offer high precision and the best operation tolerance.



DRIVE ROLLER

The EVERPADS cylindrical and patented driver roller uses reinforced rubber and special adhesive technology for longevity in large contact surface applications needing gripping friction during operation. The roller's steel supports stability while in use as the diamond-patterned surface effectively avoids asphalt adhesion.

A large tracked asphalt paver machine is shown in operation on a construction site. The machine is a complex piece of heavy machinery with a large hopper at the back for asphalt mix, a wide paving drum in the middle, and a screed at the front. It is equipped with a rubber track system for movement. Several workers in hard hats and safety vests are visible around the machine, some standing and others operating the controls. The scene is set outdoors with trees in the background.

ASPHALT PAVER

Asphalt pavers are the heroes of highway construction, effortlessly laying down beautiful and precisely-engineered surfaces. Without them, road projects would be more costly in both time and manpower to obtain an even grade along the entire expanse. EVERPADS uniquely optimizes the undercarriage system for asphalt pavers to perform constantly with higher efficiency with our world-renowned bolt-on E15 rubber track pad.

E-GENERATION RUBBER TRACK PAD

E15 Rubber Track Pad For Asphalt Paver: Design For Purpose

Asphalt pavers, working in high heat and with sticky particles, face challenges in maintaining smooth applications. Our specially designed E15 compound combats these issues by resisting heat and particle adhesion on rubber pads, reducing wear and maintenance costs. Moreover, E15's unique molecular structure extends service life and supports higher loads, making it perfect for heavy machinery in tough conditions.

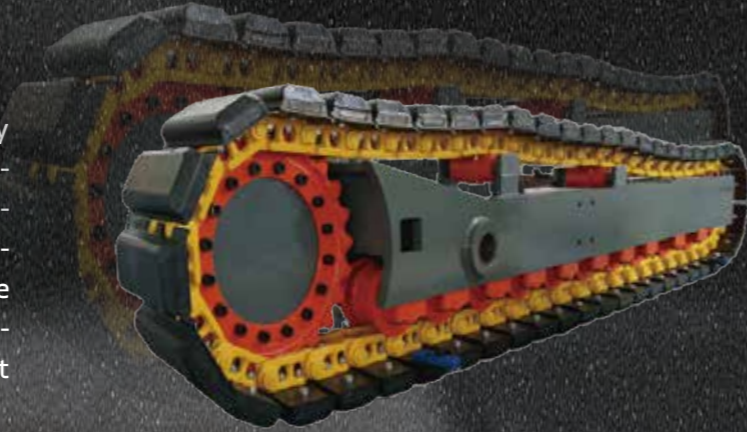

E15 Formula Performance:

3300 working hours

up to 3,300 actual working hours, surpassing the top 30% of products in the average market that last only up to 1,500 hours.

2000 working hours guarantee

Enjoy over one and a half years of guaranteed performance, reducing the need for frequent replacements.

Certified Performance

Our commitment to transparency and excellence is reinforced by SGS third-party certifications, guaranteeing that you receive a product meeting the highest standards.

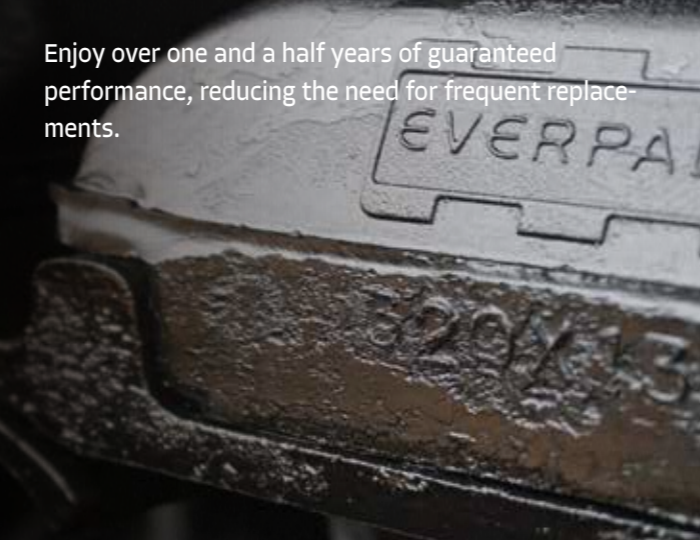

E15 Compound Specialized for Asphalt Paver



Heat-Resistant Rubber Surface:

Specifically designed to perform under high temperatures, ensuring reliability during hot mix asphalt applications.



Oil-Resistant Rubber Surface:

Our track pads resist oil and other chemicals, maintaining integrity in challenging work environments.

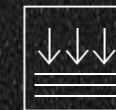

Higher Stability for Smooth Paving:

Experience enhanced stability for a flawless paving finish, crucial for high-quality road construction.

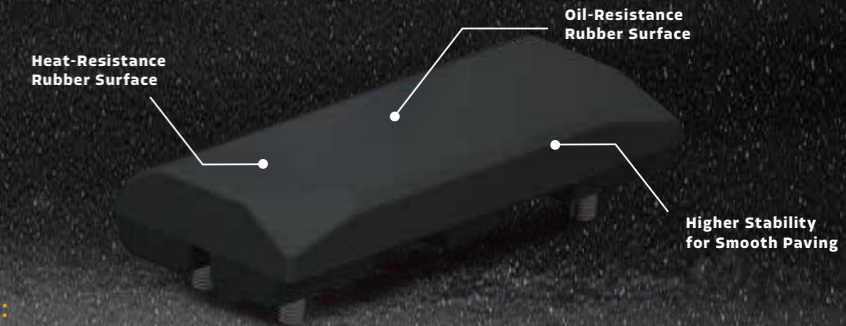

FORMULA E LOW-HEAT GENERATION TECHNOLOGY

Formula E technology extends the service life of our track pads up to 2x or more compared to other brands on the market, saving owners/operators money with added longevity. Each unique compound produces a quality composition designed to meet the specific challenges of various types of heavy equipment.

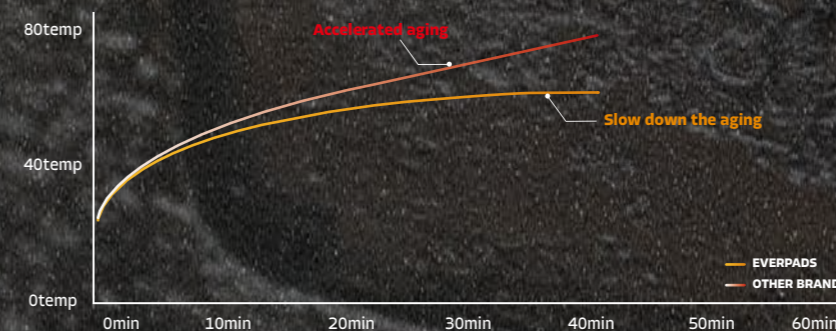

INNOVATION RUBBER COMPOUNDS

With more than 60 years of rubber experience, originating from agricultural equipment to the heavy machine industry, we have extensive knowledge and understanding of what rubber compounds best suit the applications you need.

HIGHEST QUALITY GRADE OF MATERIALS

We selectively choose our rubber raw material suppliers with criteria to ensure our final products maintain longevity, quality, and stability. Only new, quality material provides the durability that heavy machinery requires. Therefore, our process at this stage is one of the most crucial aspects of the lifecycle of our manufacturing process.



VIBRATORY ROLLER



FORMULA E RUBBER BUFFER FOR VIBRATORY ROLLER

The Formula E Rubber Buffer series for rollers is designed for surface compaction construction. It provides up to 3 times the service life compared to standard buffers, even when used with high-weight rollers and under centrifugal force.

3X Service Life Extension

3,200+ Working Hours

Low-Heat Generation

APPLICATION: TAILORED FOR VARIOUS ROLLER SPECIFICATIONS

6 Ton Rollers

Optimized for compact and efficient operations, perfect for small-scale projects and tight spaces.

12 Ton Rollers

Ideal for medium-duty compaction tasks, balancing maneuverability and compaction force for varied construction sites.

20 Ton Rollers

Engineered for large-scale projects, delivering robust compaction capabilities and consistent performance in demanding environments.

30 Ton Rollers

The ultimate choice for heavy-duty compaction, providing maximum force and depth for large and intensive construction projects.

Up to 3,200 working hours in surface compaction operations.

- 3x the service life of standards: low heat generation technology
- Withstands higher centrifugal force load
- Adds more than 3,200 working hours

Key Features

1. Low-Heat Generation Technology: Our Formula E technology maintains rubber temperature at 63 ° C (145 ° F), slowing rubber aging and preserving physical properties like tear resistance and tension.
2. Tear Resistance Compound: Advanced material formulation enhances mechanical stress resistance, minimizing tears, cracks, and maintenance costs. Collaborates with Roller OEMs for optimal compound selection.

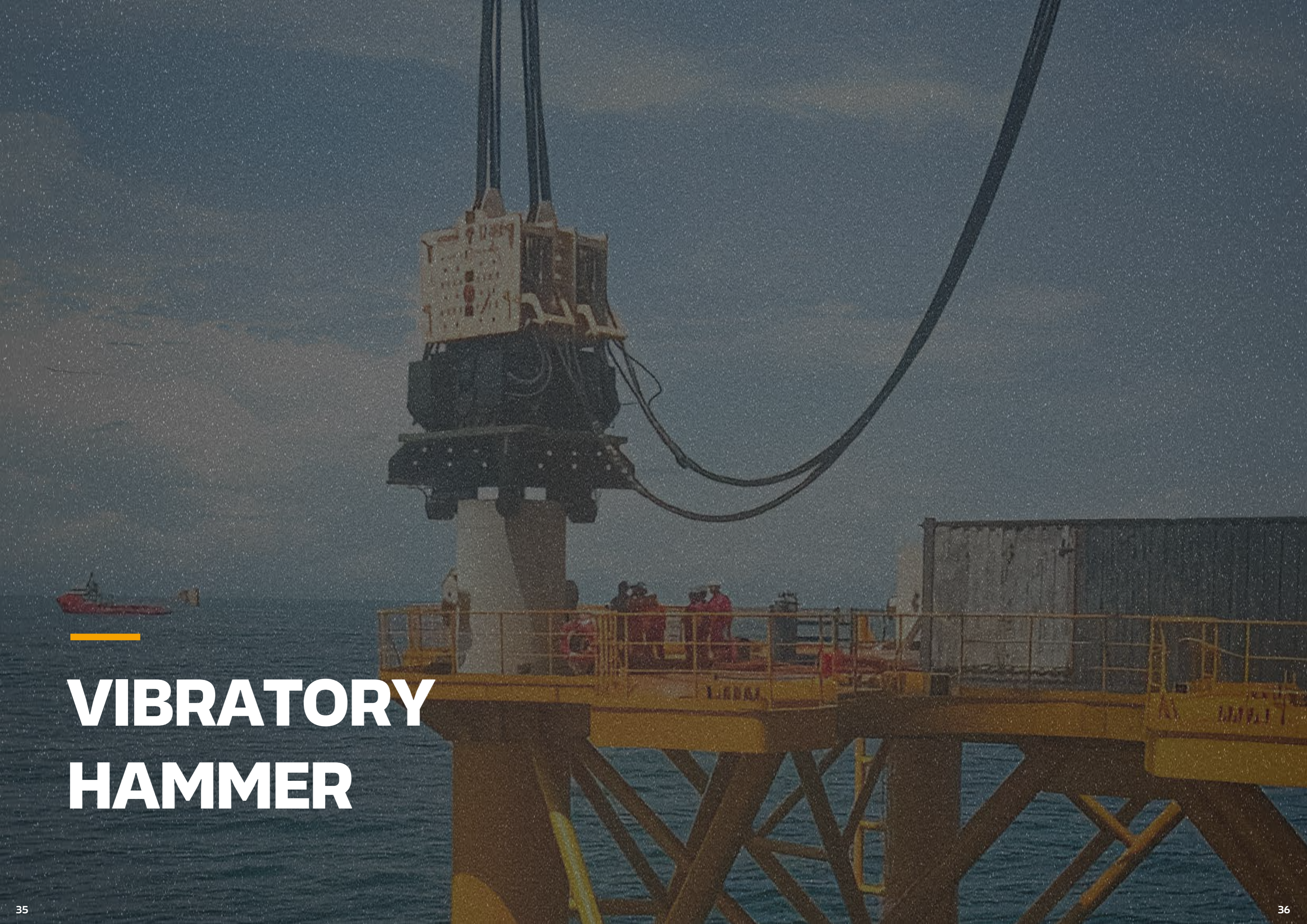

VIBRATORY HAMMER



FORMULA E RUBBER BUFFER FOR VIBRATORY HAMMER

Experience unparalleled durability and performance with the Formula E Rubber Buffer series, designed specifically for vibratory hammers in deep foundation work. Featuring advanced low-heat rubber technology and tear-resistant compounds, these buffers are built to endure the intense demands of driving and extracting operations, offering up to three times the standard service life.

3X Longer Lifespan

Withstand over **120 kN** Force Customization

Advanced Adhesion Technology

Gain up to 3x the service life.

- 3x the service life than standards: low heat generation technology
- Customizes maximum driving / extracting force based on need: currently up to 120 kN
- 6 adhesive treatments to prevent unexpected rupture
- Triple-treated steel plate for your harshest work project

FORMULA E Low heat Generation Rubber Technology

1. EVERPADS' Formula E technology combats rubber degradation from thermal stress in vibratory hammers by maintaining rubber temperature at 63°C (145°F).
2. The innovative rubber molecular reformulation significantly reduces aging, maintaining critical physical properties like tear resistance and tension.
3. This technology extends the rubber elements' service life by 3-4 times, leading to 60-72% savings in maintenance costs and eliminating downtime expenses.

Tear-resistant Special Rubber Compound

Specifically engineered to resist high stress and strain, our rubber compound withstands the rigorous forces encountered during vibratory hammer operations, reducing the risk of cracks and deformities.

Enhanced Treatments with Steel Plate

Utilizes a multi-processing treatment approach, including heating, electroplating, and anti-corrosion treatments, to enhance steel plate durability under vibratory hammer use.

These treatments improve wear resistance and protect against environmental damage, ensuring long-term functionality and reduced maintenance costs.

Superior Adhesion with Six Unique Adhesive Treatments

Features six unique adhesive treatments to secure the rubber to steel plates, ensuring reliable performance under demanding conditions.

These treatments offer advanced bonding capabilities, combining chemical and mechanical techniques to meet specific operational needs.



**ADVANCED TESTING AND
QUALITY ASSURANCE**

RUBBER FATIGUE TESTING

Fatigue testing evaluates the ability of our rubber elastomers to withstand repeated stresses and strains, ensuring that they can perform effectively over an extended period.



TEAR RESISTANCE TEST

We also conduct rubber pulling tests to assess the tear resistance capability of our rubber elastomers. This testing allows us to ensure that our products meet the highest standards for tear resistance, providing maximum protection against wear and tear.



SHEAR FORCE TESTING

We conduct shear force testing to evaluate the extracting force of our rubber elastomers, ensuring that they meet the specific requirements of our clients' applications. By conducting these comprehensive testing procedures, we can provide our customers with the assurance that our rubber elastomers are capable of performing effectively under even the most demanding conditions.





EXCAVATOR

E22 RUBBER TRACK PADS FOR EXCAVATORS

Elevate your excavator's performance with the E22 Rubber Track Pads, designed to conquer the toughest terrains. These track pads are engineered using specialized E22 Rubber Technology, providing exceptional durability and resistance against cuts and wear. Ideal for operations in demanding environments like railroads, glassworks, and disposal areas, the E22 ensures prolonged service life and reduced maintenance costs, making it the optimal choice for heavy-duty excavation work.

6,000 Hours Service Life

2X Service Life Extension

Cut-Resistance

INNOVATIVE E22 RUBBER TECHNOLOGY

The E22 track pads, engineered specifically for excavators, excel on challenging surfaces like railroads, glassworks, and disposal sites.

Their cut-resistant formulation drastically lowers the frequency and costs associated with replacements.

Features Formula E's signature low-heat generation technology, effectively doubling the service life of the pads.

E22 KEY ADVANTAGES FOR EXCAVATORS:



Cut-Resistance: The rubber's molecular composition is designed to withstand sharp and rugged terrains, reducing wear and tear.



Tear Resistance: Capable of navigating rough surfaces smoothly, minimizing localized damage.

Low-Heat Generation: Withstands heat from sunlight exposure, preventing rubber fatigue and extending the track pads' lifespan.

Extended Service Life: Offers up to 6,000 hours of service, providing long-term reliability and performance.

EVERPADS CO., LTD.

Tel. +886 4 2358 2531/2000

Fax. +886 2358 9090

Add. No.83,32nd Road, Taichung
Industrial Park, Taichung,
40768,Taiwan ROC

Email. service@everpads.com

EVERPADS INC.

Tel. +1 215 420 7086 (toll free)

Fax. +1 888 928 7237

Add. 320 Constance Dr,Suite 5
Warminster , PA 18974

Email. america@everpads.com

EVERPADS B.V.

Tel. +31 10 415 7820

Fax. +31 10 415 6414

Add. Calandstraat 81,
3125BA,Schiedam,
the Netherlands

Email. everpads.bv@everpads.com

| COLD MILLING MACHINE

| ASPHALT PAVER

| VIBRATORY ROLLER

| VIBRATORY HAMMER

| EXCAVATOR

